

MUB/T 100 630D4-K2-L IE2

Item no. 34534

Description

- High efficient motor IE2
- Speed-controllable via frequency converter
- Integral cold conductor (PTC)
- Low sound level
- Max temperature of transported air up to 120°C
- Easy to maintain and reliable

The MUB/T Thermofans size 630D4-K2 are equipped with high efficient IE2 motors. The MUB/T fans have impellers with backward curved blades, manufactured from aluminum, and IE2 standard motors, which can be speed controlled via frequency converter. Motors are outside the air stream. The casing consists of an aluminum frame with fiberglass reinforced plastic corners and double skin, galvanized steel panels with a 20 mm mineral wool insulation. Panels are removable, allowing flexible ventilation solutions. With quick lock access door. The MUB/T casing is equipped with a condensate tray under the impeller and a protection guard at the motor side. An isolator switch is mounted on the casing. Motor protection is done by cold conductors (PTC), which have to be connected to an external motor protection device. Standard execution, seen in airflow direction: service door left, top outlet. The MUB/T fans are delivered to 90° air direction airflow.

MUB with additional modules (filters, heaters etc.) are available as air handling units "K025, K042 or K062" on request!

Please note: IE2 motors cannot be speed controlled by voltage, i.e. voltage transformers.



In accordance with Commission Regulation (EC) no 640/2009 of the European Parliament - eco-design requirements for electric motors - the new international efficiency classes are binding as of 16 June 2011. These guidelines defined by CEMEP and EPACT are regarded as international standard for energy-saving high-efficiency motors for frequencies of 50 or 60 Hz and make the use of IE2 motors mandatory.

With this new and more efficient technology we offer our customers many advantages such as environmentally friendly operation, reduced energy consumption and hence lower emissions. IE2 motors have a higher efficiency even in part load operation and allow optimum adjustment to the operating point. In addition, the IE2 motors generate less noise and develop less heat, which has a positive influence on the efficiency and the cooling requirement of the motor. Please note: IE2 motors cannot be speed controlled by voltage, i.e. voltage transformers.

Technical parameters

Nominal data	
Voltage	400 V
Frequency	50 Hz
Phase	3 ~
Motor circuit connection	D
Input power (P1)	5477 W
Current	9,47 A
Max. airflow	20336 m³/h
Fan impeller speed	1435 r.p.m.
Weight	195 kg
Temperature data	
Max. temperature of transported air	120 °C
Sound data	
Sound pressure level at 3 m (20m² Sabin)	74 dB(A)

Protection / Classification

Insulation class	F
Enclosure class, motor	IP54

Default group

Starting current	60,9 A
------------------	--------

Performance

Diagrams

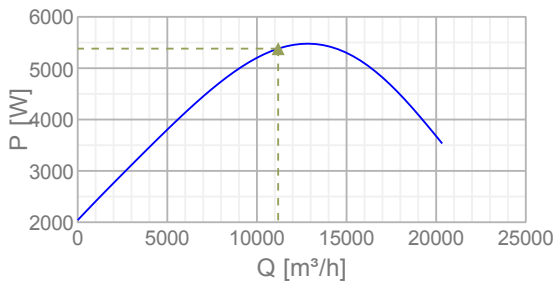
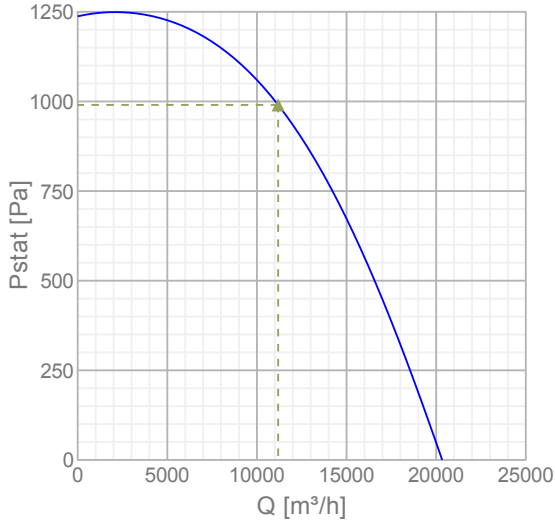

Max efficiency

Hydraulic data

▲ Working air flow	11185 m ³ /h
▲ Working static pressure	990 Pa
▲ Power	5381 W
Speed	1436 r.p.m.
Current	9,35 A
SFP	1,73 kW/(m ³ /s)
Voltage	400 V

EPS diagrams

Dimensions

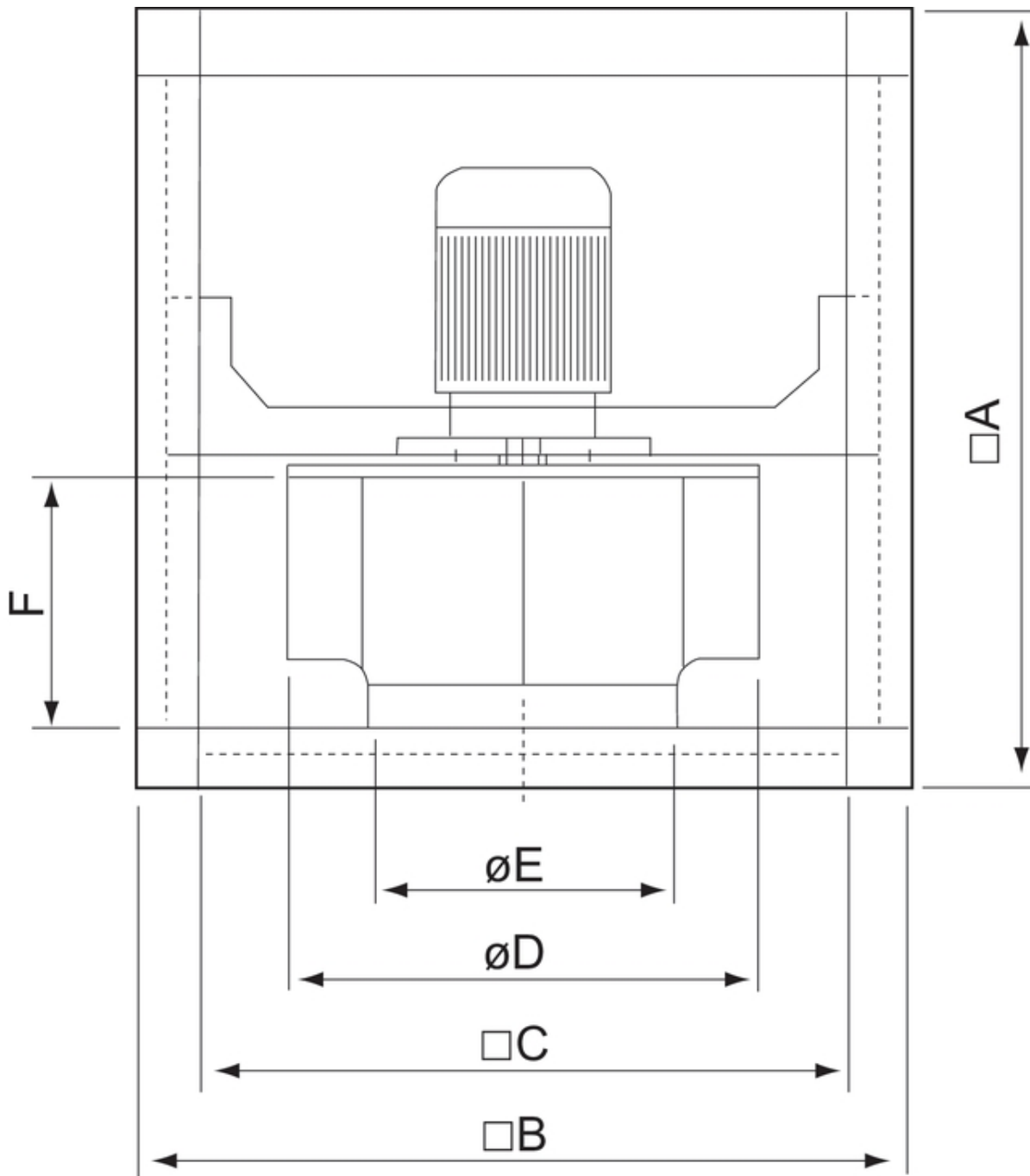

$\square A$	$\square B$	$\square C$	$\square D$	$\square E$	F	
MUB 100 630	1000	1000	918	635	389	378

Dreiphasenmotor mit Kaltleiter
Three phase motor with cold conductor
Moteur triphasé avec résistance PTC

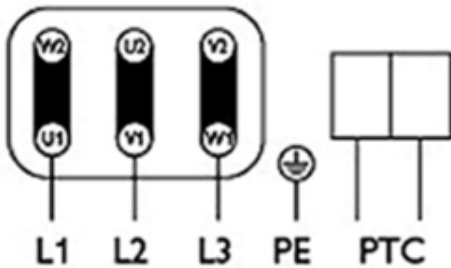

3 x 400V
D Schaltung
Delta connection
Branchement en triangle

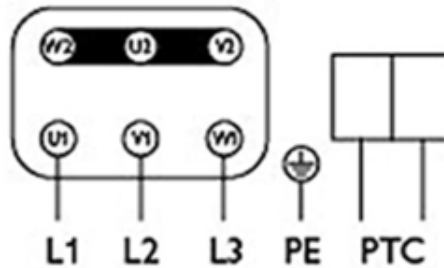

3 x 690V
Y Schaltung
Star connection
Branchement en étoile

Drehrichtungsänderung durch Vertauschen von 2 Phasen
Changing of direction of rotation by interchanging of two phases
Changement de sens de rotation par inversion de deux phases

Typenschild beachten! See label! Voir plaquette!

Accessories

Electric accessories

- [U-EK230E Motor protection \(30199\)](#)
- [FXDM14AM Frequency inv. IP54 \(31389\)](#)
- [REV-5POL/05 ON/OFF \(33979\)](#)
- [REV-5POL/05 incl. EMC KIT \(34549\)](#)
- [FRQ5S-10A+LED V2 \(36234\)](#)
- [FRQ5-10A+LED V2 \(36230\)](#)
- [FRQS-10A V2 \(36232\)](#)
- [FRQ-10A V2 \(36228\)](#)

Accessories

- [ALS-KBR drain plug \(2727\)](#)
- [FGV 100/916-916 flex. conn. \(4199\)](#)
- [WSD 100 \(1060x1060x70\) compl. \(31483\)](#)
- [SD-MUB Vibration pad set \(37324\)](#)
- [FGV 100/916-916 flex. 120°C \(38363\)](#)
- [TUNE-AHU-DE009-100-918x918-M0 \(79883\)](#)

Documentation

 [manual_mub_all_en_\[008\].pdf \(2,29MB\)](#)

 [eu declaration of conformity_thermofans_en_\[002\].pdf \(46,39kB\)](#)

 [Commissioning Report_fans_160628_en_001.pdf \(42,79kB\)](#)

Acoustics

Mid-frequency band, Hz

630D4-L	Hz	Tot	63	125	250	500	1k	2k	4k	8k
LwA Inlet	dB(A)	87	58	76	80	82	81	78	73	65
LwA Outlet	dB(A)	89	60	78	82	84	83	80	75	67
LwA Surrounding	dB(A)	81	52	70	74	76	75	72	66	59

Measuring point: $q_v = 3,1 \text{ m}^3/\text{s}$, $P_s = 990 \text{ Pa}$

Specification text